



Car Parking Rules and Guidelines

These guidelines have been produced to help ensure the safety of all visitors, parents, children, and staff at Royal American School and we are grateful for your full cooperation. This document forms part of the risk assessment for the safety of everyone entering or leaving the school site. Parents and guardians are reminded that they are responsible for their children in the car park, and they should be closely always supervised.

- Gates are designated as the following:
 - **Gate#1:** School Staff and Visitors
 - **Gate#2:** School Buses Area
 - **Gate#3:** Not in use
 - **Gate#4 and Gate#5:** (Grades 1-12) Parents' Parking lots during students' drop-off and pick-up
 - **Gate#6:** KG Parents' Parking lots during students' drop-off and pick-up
- A **10 KM** per hour speed limit applies throughout our site.
- When driving and maneuvering in the parking lot, all drivers must be cautious and attentive.
- All Parents and guardians are encouraged, where possible, to walk their children to school.
- Parents and guardians must only park properly in the parent's car park. (Gate# 5) Blocking streets will not be acceptable.
- Only registered disabled students or with medical condition (Permission holders) can use (Gate# 1) to enter and leave the school premises.
- Access for emergency vehicles must be maintained in front of (Gate# 1) at all-time. Parking is not permitted in front of any other gate.
- When parking, it is preferable that the front of the car be directed to the outside of the parking
- The use of the school parking lot is at the user's own risk. Royal American School will not be held liable for any loss or damage to vehicles or belongings that may occur.
- Pedestrians are to keep to the pathway and not walk across the car park area.





مدرسة رويال الامريكية
ROYAL AMERICAN SCHOOL

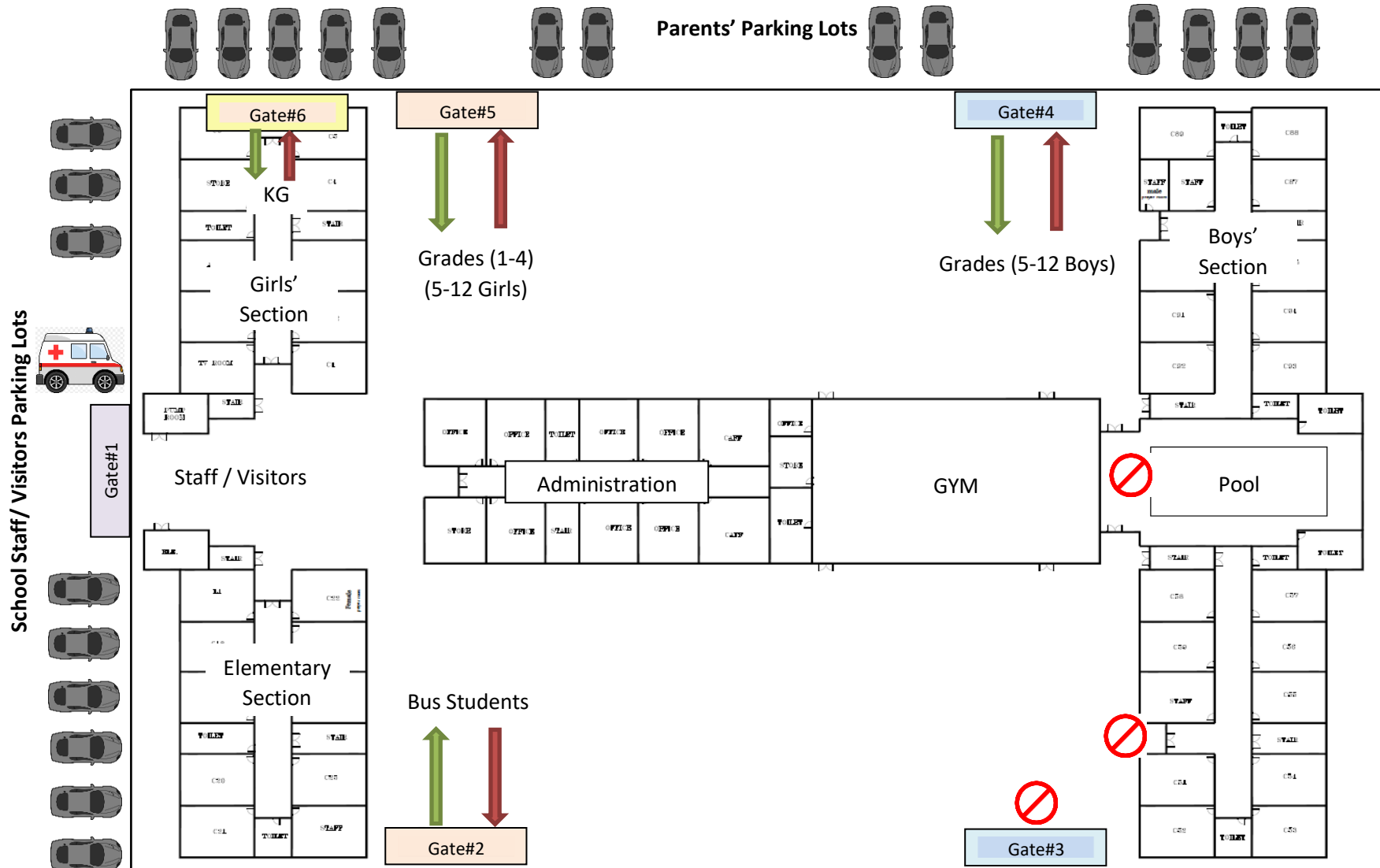

Health and Safety Team

